



G r y G o n 16

CONTENTS

Program	1
Friday	2
Saturday	6
Sunday	14
Gaming	18
Hotel Map	22
Schedule Grids	24
Video	30
Restaurant and Services Guide	34
Notes	44
Area Map	45
OryCon At A Glance	Back Cover

CREDITS

This pocket program was produced by Dave Hicks. Real Musgrave did the cover; the programming schedule is an Andrew Nisbet production with enhancements by Linda Pilcher and Page Fuller; the video schedule was written by Fred Torck and Anne Peck; the restaurant and services guide was written by Pat MacAodha; both maps are by David Levine; and the gaming schedule was written by David Schaber. All the rest including my theory of the Brontosaurus is mine, mine alone and you cannot have it!

PROGRAM

Small Group Discussions

Small group discussions will be held in the Riverview Room on Saturday afternoon. These programs last 90 minutes. Some are discussion groups, some are workshops and some are lectures.

These events are limited attendance. Sign up in the Office starting on Friday. If there are spaces left over on the sign-up sheet when the event starts, walk-ins are welcome to join until the event is filled.

For a listing of the small group discussions, see the main program starting at noon Saturday (Riverview 2-7). These discussions are not detailed in the schedule grids due to lack of space.

Saturday Costuming Track

Several Costuming panels will take place in the Riverview room at the same time as the small group discussions. These panels will take place on the stage. (Riverview Stg.)

Masquerade Practice

Masquerade practice starts at 3:00 on the Riverview stage. Sign up is required, look for the Masquerade Committee Head at the table next to Registration in the Main Lobby.

Whose Line Is It Anyway?

Has moved to the Klamath room at 6:00 PM on Saturday. We will be collecting funny lines and scenes in boxes at the beginning of the panel.

FRIDAY

Friday 8:00 AM

Clackamas Office opens

Friday 9:00 AM

Art Show Artists' Check-in opens

Friday 11:00 AM

Lobby Registration opens

Friday Noon

Umatilla Is the Ultimate Human Interface A Direct Plug To Your Brain?

John De Camp, Elton Elliot, Norm Hartman, Alan Olsen

Dealers' Rm Dealers' Room opens

Friday 1:00 PM

Umatilla Comics That Are Not The Big Two

Gary Davis, Fred Patten, Drew Sanders

Yakima How Cons Should Treat Pro's - How Pro's Should Treat Cons

Clifton Amsbury, Lionel Fanthorpe, Amy Thomson, Patty Wells, Ben Yalow

Art Show Artists' Check-in closes

Friday 2:00 PM

Umatilla The Third World Today and Tomorrow

James W. Fiscus, T. Jackson King, Mike Moscoe, Andrew Nisbet

Yakima What To Get From a Writer's Workshops

Mark Bourne, Elton Elliot, Bridget McKenna, Rebecca Neason, Dean Wesley Smith

Art Show Art Show opens

Friday 3:00 PM

- Klamath Craters of Doom: Volcanologists vs Visionaries
Geologist Janet Tanaka has all the lowdown on lava.
- Umatilla Art & Art Shows
Real Musgrave, Margaret Organ-Kean, Elayne Pelz, Leonardo Rufo
- Yakima Science Fiction & Fantasy Poetry
John De Camp, Lionel Fanthorpe, Lenora Good
- Kennedy Hospitality opens

Friday 3:30 PM

- Room 114 Reading: Deborah Wheeler

Friday 4:00 PM

- Klamath Conscious & Subconscious Elements of the Creative Process
Steven Barnes, Pat Cadigan, Lionel Fanthorpe, Tappan King, Beth Meacham
- Umatilla Technospeak - How To Use It Right
Howard Davidson, Paula Downing, Lenora Good, David Levine
- Yakima Would You Please Remove Your Religion
Clifton Amsbury, Betty Bigelow, Aubrey McDermott, Janet Tanaka, Theo Williams, Tom Billings
- Room 114 Reading: Norm Hartman
- 172, 174 Child Care opens
- Santiam Fan Room opens
- Gaming Rms Gaming opens
- 417, 419 Video Rooms open

Friday 4:30 PM

- Room 114 Reading: Elton Elliott

Friday 5:00 PM

- Klamath Guest of Honor Interview
 Guest of Honor Tappan King will interview Guest of Honor Pat Cadigan. Come and learn about this writer's truths or stories.
- Yakima Adaptation or Exploitation? - Borrowing from other
 Cultures' Myths
John Bunnell, Margaret Forsythe, T. Jackson King, Marilyn Mor
- Umatilla Wizards of the Coast
 Room 114 Reading: Sonia Orin Lyris

Friday 5:30 PM

- Room 114 Reading: Adrienne Martine-Barnes

Friday 6:00 PM

- Klamath Lionel Fanthorpe Reading
 Debbie Cross presents the writings of her favorite author.
- Umatilla Folktales and Fantasy: The Musical Connection
Heather Alexander, David Bratman, John Bunnell, Lionel Fanthorpe, Rebecca Neason
- Yakima A Civilized Ideal: Disagreement With Out Flames
John De Camp, Sonia Orin Lyris, Mike Moscoe, Alan Olsen, Chuq von Rospach
- Room 114 Reading: Steven Barnes
 Santiam Fan Room closes

Friday 6:30 PM

- Room 114 Reading: R. V. Branham

Friday 7:00 PM

- Room 114 Reading: John Bunnell
 Dealers' Rm Dealers' Room closes

Friday 7:30 PM

- Riverview Opening Ceremonies

Friday 8:00 PM

- Riverview Dance
The Dance begins right after Opening Ceremonies and runs until 3 AM.
- Klamath Concert: Steve Dixon
Santiam Fan Room opens

Friday 8:30 PM

- Klamath Concert: Rebecca Neason
Yakima Costume Con 14: What is it? Why You Should Attend?
Costume Con Committee
- Umatilla Trivia Quiz
Room 114 Reading: Mary Rosenblum
423 Quiet Hospitality opens (after Open. Ceremonies)

Friday 9:00 PM

- Klamath Concert: Steve Prescott
Santiam Fanorama
David Levine, Mark Manning, Amy Thomson
- Room 114 Reading: Ray Vukcevich

Friday 9:30 PM

- Klamath Concert: Elizabeth Ann Scarborough
Yakima Blood Fleet : What is it? Why you should Care!!!

Friday 10:00 PM

- Klamath Concert: Lionel Fanthorpe
172, 174 Child Care closes
Lobby Registration closes

Friday 10:30 PM

- Klamath Concert: Cecilia Eng

Friday 11:00 PM

Klamath Bardic Circle
Santiam Fan Room closes

Friday Midnight

Room 114 Midnight Horror Reading
Lionel Fanthorpe, John DeCamp, Edd Vick

Saturday 1:00 AM

423 Quiet Hospitality closes

Saturday 3:00 AM

Kennedy Hospitality closes

Saturday 4:00 AM

Gaming Rms Gaming Rooms close
417, 419 Video Rooms close
Klamath Filking closes
Clackamas Office closes

SATURDAY

Saturday 8:00 AM

Clackamas Office opens
Gaming Rms Gaming opens
417, 419 Video Rooms open

Saturday 9:00 AM

Yakima SF Museum Presentation
Ed Stiener
Riverview Tai Chi With Steve Barnes

Saturday 9:00 AM (cont'd)

Kennedy Hospitality opens

Saturday 10:00 AM

Riverview SCA Demonstrations

Klamath Ask Dr. Genius

Marc Bourne, Pat Cadigan, Robert L. Forward, Amy Thomson, Steve York

Umatilla No Dogs or Adults Allowed: Let's Write A Story Now.

Lionel Fanthorpe and Jane Hawkins

This is for ages 5 to 14.

Yakima Oregon Christian Fandom

Art Show Art Show opens

172, 174 Child Care opens

Dealers' Rm Dealers' Room opens

Lobby Registration opens

Saturday 11:00 AM

Klamath Research for Alternate History

Lionel Fanthorpe, James Fiscus, Tappan King, Beth Meacham

Umatilla No Dogs or Adults Allowed: High School Writer's

Workshop

Mary Rosenblum, Danielle Perry

Yakima Gnome, Gnome on the Range - Humorous Fantasy

John Bunnell, Kent Patterson, Elizabeth Scarborough, Elisabeth Waters

Santiam Fan Room opens

Santiam Gestetners and Modems

Ctein, David Levine, Jackie Nilsson, Chuq von Rospach

Art Show An Art Show Walk Through

*Jon Gustafson***Saturday 11:30 AM**

Dealers' Rm Autographs: Adrienne Martine-Barnes and Steve York

Saturday NOON

- Klamath Four Interesting and Vital People Talking About Nothing in Particular
Steven Barnes, Pat Cadigan, Lionel Fanthorpe, Amy Thomson
- Umatilla No Dogs or Adults Allowed: Music With a Younger Bent
Steve Dixon
- Yakima Running small conventions
Chris Nilsson, Sharon Sbarsky, Suzie Tompkins, Julie Zetterberg, Alan Smith, Nancy Smith
- Dealers' Rm Autographs: Dean Wesley Smith and Deborah Wheeler
- Riverview Stg Movement in Costume - Why Does My Cape Just Hang There?
Gordon Hayes, Susan Taubeneck

Riverview group discussions are 90 minutes. Sign up in the office.

- Riverview 2 Fear and Loathing of Tomorrow: Are SF Writers Afraid of the Future?
Elton Elliot, R.V. Branham
- Riverview 3 Deeply Fascinating Stuff about Libraries and Librarians
Flora Persons
- Riverview 4 Why Can't People Program Their VCR's and Other Human Interface Questions.
Jerry Oltion
- Riverview 5 Art Techniques: Scratch Board and Colored Pencils
Jacqualynn Nilsson
- Riverview 6 How to be a Game Master
David Schaber, Edd Vick
- Riverview 7 Network Access: Elitism of the Future?
Kent Patterson, Mary Rosenblum, Theresa ReedSimmons

Saturday 12:30 PM

- Dealers' Rm Autographs: David Bischoff and Elisabeth Waters

Saturday 1:00 PM

- Klamath When Your Editor Wants a Rewrite
Pat Cadigan, Tappan King, Beth Meacham, Mike Moscoe, Dean Wesley Smith
- Umatilla No Dogs or Adults Allowed: Karate Workshop
For the 16 and under crowd only.
- Yakima Faire Music and Filk Music
Heather Alexander, Lionel Fanthorpe, Michael Longcor, Cecilia Eng
- Santiam Why Do People Write For Fanzines Anyway
Jane Hawkins, Jerry Kaufman, Aubrey MacDermott
- Dealers' Rm Autographs: Real Musgrave and Margaret Organ-Kean

Saturday 1:30 PM

- Dealers' Rm Autographs: Elizabeth Scarborough and Ray Vukceвич
- Riverview Stg Elements of Stage Performance For Costumers
Betty Bigelow, Gary Davis, Drew Sanders, Pippen Sardo

Saturday 2:00 PM

- Klamath Guests of Honor Interview
Patrick Nielsen Hayden will ask the questions of our Guests of Honor, Tappan King and Beth Meacham.
- Umatilla First Fandom
Clifton Amsbury, Aubrey McDermott, Bruce Pelz
- Yakima How to Make Your Fantasy Art Look Believable (Or Should You?)
Gail Butler, Margaret Organ-Kean, Leonardo Rufo
- Dealers' Rm Autographs: Lionel Fanthorpe and Elton Elliott

Riverview group discussions are 90 minutes. Sign up in the office.

- Riverview 2 Humor In Costuming - What Works, What Doesn't.
Joy Day and Julie Zetterberg
- Riverview 3 Critiquing Writing - How and Why
Mary Rosenblum and Dean Wesley Smith

Saturday 2:00 PM (cont'd)

- Riverview 4 Constructing a Consistent Ethnography
Margaret Forsythe and Marilyn Mor
- Riverview 5 The Future of Faster Than Light
Robert L. Forward
- Riverview 6 Mask Making
Adrienne Martine Barnes
- Riverview 7 Costs and Joys of Virtual Reality
Sonia Orin Lyris
- 423 Quiet Hospitality opens

Saturday 2:30 PM

- Dealers' Rm Autographs: Steve Barnes and Robert Sheckley

Saturday 3:00 PM

- Klamath Real Musgrave Slide Show
Real Musgrave
- Yakima Trading Card Games - The Next Wave or the Next Pet Rock?
Andrew Nisbet, Margaret Organ-Kean, Drew Sanders, David Schaber
- Umatilla Two Guys Named Steve
Steven Barnes and Steve Perry
- Santiam Sixty-Year Spree: A Brief History of Fanzine Fandom
Jerry Kaufman, Mark Manning, Bruce Pelz, Suzanne Tompkins
- Room 114 Reading: Lenora Good
- Dealers' Rm Autographs: Tappan King and Beth Meacham
- Riverview Stg Masquerade Practice
Sign up is required. Look for the Masquerade Committee Head at the table next to Registration in the Main Lobby.

Saturday 3:30 PM

- Room 114 Reading: Lionel Fanthorpe
- Dealers' Rm Autographs: Bridget McKenna and Rebecca Neason

Saturday 4:00 PM

- Klamath Sue Petrey Auction Setup (Auction Starts at 4:30)
- Umatilla Multi-Culturalism & Bosnia - How Much Cultural Empowerment is Enough.
James W. Fiscus, Margaret Forsythe, Mike Moscoe, Andy Nisbet
- Yakima Smart kids / Stupid Schools
Tom Billings, T. Jackson King, Chris Nilsson, Jackie Nilsson, Elisabeth Waters
- Room 114 Reading: David Bischoff
- Dealers' Rm Autographs: Kristine Kathryn Rusch and Mary Rosenblum

Riverview group discussions are 90 minutes. Sign up in the office.

- Riverview 2 Prosthetic Make-up
Betty Bigelow and Gordon Hayes
- Riverview 3 Weird Science or Off-The-Wall Theories
Robert L. Forward, Norm Hartman, Amy Thomson, Janet Tanaka
- Riverview 4 American Mythology of the Future
Jerry Kaufman and Haroldine Nisbet
- Riverview 5 How to Invest in SF Art: Reselling
Jon Gustafson
- Riverview 7 Life Writing
Steven Barnes

Saturday 4:30 PM

- Klamath Sue Petrey Auction
- Room 114 Reading: Elizabeth Ann Scarborough

Saturday 5:00 PM

- Umatilla Cyberpunk Women - Better than California Girls?
Steve Barnes, Pat Cadigan, John DeCamp, Sonia Orin Lyris, Jerry Oltion, Kent Patterson

Saturday 5:00 PM (cont'd)

- Yakima Sense of Place in Fantasy
David Bratman, Paula Downing, Rebecca Neason, Elizabeth Ann Scarborough, Danielle Perry
- Room 114 Reading: Kristine Kathryn Rusch
423 Quiet Hospitality closes

Saturday 5:30 PM

- Room 114 Reading: Steve York

Saturday 6:00 PM

- Umatilla Getting Noticed: Self Promotion for the Artist
Real Musgrave, Muff Musgrave
- Klamath Whose Line Is It Anyway
Steve Barnes, Mark Bourne, Lionel Fanthorpe, David Levine, Amy Thomson
Come to the show with bizarre lines and funny scenes you'd like to see acted out. 90 minutes.
- Yakima New Age, Folk, and Ethnic Music
Heather Alexander, Joan Gaustad, Meryle Korn, Elizabeth Ann Scarborough, Roy Torley
- Room 114 Reading: Dean Wesley Smith
- Riverview Masquerade Setup
- Lobby Registration closes
- Santiam Fan Room closes
- Dealers' Rm Dealers Room closes

Saturday 6:30 PM

- Room 114 Reading: Margaret Forsythe

Saturday 7:00 PM

- Umatilla Buck Rogers Meets the Spotted Owl.
Mike Moscoe, Tim Campbell, R.V. Branham
- Room 114 Reading: Rebecca Neason

Saturday 8:00 PM

- | | |
|-----------|----------------------------------------------------------------------------------------------------------------------------------------|
| Klamath | Bardic Circle |
| Umatilla | Is There Such A Thing As Good Space Opera?
<i>Lionel Fanthorpe, Mike Moscoe, Rebecca Neason, <u>Kent Patterson</u>, Steve Perry</i> |
| Riverview | Masquerade |
| Art Show | Art Show closes |

Saturday 9:00 PM

- | | |
|----------|-------------------------------------------------------------------------|
| Umatilla | Oak Island Mystery and the Rennes-le-Chateau
<i>Lionel Fanthorpe</i> |
| Santiam | Fan Room opens |

Saturday 10:00 PM

- | | |
|-----------|----------------------------|
| Riverview | Dance |
| Klamath | Concert: Heather Alexander |

Saturday 10:30 PM

- | | |
|---------|--------------------------------------------|
| Klamath | Concert: Roy Torley and Joan Gaustad |
| 423 | Quiet Hospitality opens (after Masquerade) |

Saturday 11:00 PM

- | | |
|----------|----------------------|
| Klamath | Concert: Meryle Korn |
| 172, 174 | Child Care closes |
| Santiam | Fan Room closes |

Saturday 11:30 PM

- | | |
|---------|--------------------------|
| Klamath | Concert: Michael Longcor |
|---------|--------------------------|

Saturday MIDNIGHT

- | | |
|----------|---------------------------------------------------------------------------------------------|
| Klamath | Bardic Circle |
| Room 114 | Midnight Horror Reading
<i>David Bischoff, Mark Bourne, Jane Hawkins, Ray Vukceovich</i> |

Sunday 1:00 AM

423 Quiet Hospitality closes

Sunday 3:00 AM

Kennedy Hospitality closes

Sunday 4:00 AM

Gaming Rms Gaming Rooms close

417, 419 Video Rooms close

Klamath Filking closes

Clackamas Office closes

SUNDAY

Sunday 8:00 AM

Gaming Rms Gaming opens

Clackamas Office opens

417, 419 Video Rooms open

Sunday 9:00 AM

Riverview Tai Chi with Steven Barnes

Art Show Art Show opens

Kennedy Hospitality opens

Sunday 10:00 AM

Umatilla Celebrate Mass with Reverend Fanthorpe

Lobby Registration opens

Sunday 10:30 AM

Room 114 Reading: Leslie What

Sunday 11:00 AM

Klamath	Horses and Fandom <i>Heather Alexander, <u>Tappan King</u>, Beth Meacham, Shawn Wall</i>
Umatilla	Humorous SF (Intentional and Not) <i>Clifton Amsbury, John De Camp, Lionel Fanthorpe, <u>Kent Patterson</u>, Robert Sheckley, Ray Vukceвич</i>
Yakima	Schools and Parents <i>Joan Gaustad, Jane Hawkins, Marilyn Holt, Haroldine Nisbet, Linda Pilcher, <u>Patry Wells</u></i>
Room 114	Reading: Mark Bourne
Art Show	Art Show closes
Riverview	Art Auction Setup
172, 174	Child Care opens
Dealers' Rm	Dealers' Room opens
Santiam	Fan Room opens

Sunday 11:30 AM

Riverview	Art Auction
Room 114	Reading: Amy Thomson

Sunday NOON

Klamath	Magazine Hell: The SF Magazine Field <i>Eileen Gunn, Tappan King, <u>Bridget McKenna</u>, Dean Wesley Smith, Mary Beth O'Halloran</i>
Umatilla	The Business of Writing <i>Patrick Nielsen Hayden, Beth Meacham, <u>Mary Rosenblum</u>, Ray Vukceвич, Leslie What</i>
Yakima	Masquerade Debriefing
Santiam	Amateur Press Associations (APA's) <i><u>David Bratman</u>, Jane Hawkins, Fred Patten, Amy Thomson</i>
Room 114	Reading: Paula Downing

Sunday 1:00 PM

- Klamath Con Volunteers Buy Virtual Beer for Pro's
Pat Cadigan, Michael Longcor, Real Musgrave and all the Program Participants who are available during this hour.
This is open only to the Volunteers, Pro's, and Committee Members. The volunteer prizes will also be drawn and awarded during this hour.
- Umatilla History of the Ukrainian Bandura
Joan Gaustad and Roy Torley
- Yakima How to be a SMOF
David Levine, Bruce Pelz, Sharon Sbarsky, Ben Yellow
- Room 114 Reading: Edd Vick

Sunday 1:30 PM

- Room 114 Reading: Rebecca Neason

Sunday 2:00 PM

- Klamath Cats & Dragons & Unicorns - Who Cares?
Jim Fiscus, Sonja Orin Lyris, Rebecca Neason, Fred Patten, Ray Vukceвич, R. V. Branham
- Lobby Registration closes
- Yakima How was the Con? - Onions and Orchids
- Room 114 Reading: Jane Hawkins
- Riverview Claymation
Webster Colcord

Sunday 2:15 PM

- Umatilla Chocolate Tasting
Friends of the Doctor

Sunday 2:30 PM

- Room 114 Reading: Elisabeth Waters

Sunday 3:00 PM

- Klamath Science For Rocks: How To Write Hard Science With A Soft Mind
Pat Cadigan, Howard Davidson, Paula Downing, Eileen Gunn, Mike Moscoe, Amy Thomson, Roy Torley
- Umatilla Science and Religion - Harmony or Discord?
Tom Billings, Tim Campbell, Ctein, Andrew Nisbet, Theo Williams
- Yakima Drunken Revelry: Favorite Drinking Songs and What Makes Them Work
Heather Alexander, Lionel Fanthorpe, Joan Gaustad, Rebecca Neason
- Art Show Art Show opens for Check-out.

Sunday 4 PM

- Santiam Fan Room closes
- 417, 419 Video Rooms close
- Dealers' Rm Dealers' Room closes
- Kennedy Hospitality closes
- 172, 174 Child Care closes

Sunday 5 PM

- Art Show Art Show check-out closes
- Gaming Rms Gaming Rooms close

GAMING

Welcome back to OryCon gaming! This year we have attempted to schedule a wide variety of games for your enjoyment. There will be sign-up sheets posted by the Tualatin (open gaming) room. So if you want to play one of these games, get signed up early. (Sign-up sheets will be posted at least 4 hours prior to gametime.) We also have a large selection of games to play in the open gaming (Tualatin) room, so feel free to pull out a game and have a few hours of fun!

Please confine all MAGIC playing and trading to these rooms. If you play or trade cards in the hallways or other programming space, you will be asked to go to the gaming rooms. Thank you.

OryCon gaming rooms may not be used to run games for a fee, as this activity could jeopardize our non-profit status. Alcohol will not be permitted in any of the game rooms. Food and beverages from the Hospitality room *must* stay in the Hospitality room! No lasertag, TAG, or other assassin-style games will be scheduled and none will be allowed. Violation of the gaming rules may (and probably will) result in loss of convention membership.

Remember: You will be in a small room with several others... show kindness... Personal hygiene will make the convention much more comfortable for those around you!

FRIDAY**4:00 PM Friday**

- Umpqua Gamemaster Meeting
Cthulhu
- Nestucca Magic (until 6:00 PM)
Cthulhu
- Wallowa Magic
(Trading and play)

5:00 PM Friday

- Umpqua Star Fleet Battles (until 11:00 PM)
Jeff Clulow

6:00 PM Friday

- Nestucca Cry Havoc PBM (until 11:00 PM)
James Wilsonsage
- Wallowa Ethos (until 1:00 AM)
Rod Barnes

11:00 PM Friday

- Umpqua Robin Hood (until 4:00 AM)
Mary Olsen
- Nestucca Magic (until 4:00 AM)
Calvin Taylor

1:00 AM Saturday

- Wallowa Magic (until 4:00 AM)

SATURDAY

7:00 AM Saturday

- Umpqua Jihad (until 1:00 PM)
Calvin Taylor
- Nestucca Magic (until 9:00 AM)
Cthulhu
- Wallowa Magic (until 1:00 PM)

9:00 AM Saturday

- Nestucca Cry Havoc PBM (until 1:00 PM)
James Wilsonsage

1:00 PM Saturday

- Umpqua Battletech Level 2 (until 6:00 PM)
Rodney Barnes
- Nestucca Chill (until 6:00 PM)
Karl Kreibiel
- Wallowa ITL (until 6:00 PM)
Jeff Peck

6:00 PM Saturday

- Umpqua Battletech Level 3 (until 11:00 PM)
Rodney Barnes
- Nestucca Magic Tourney (until 11:00 PM)
Cthulhu
- Wallowa Magic Tourney (until 11:00 PM)
Cthulhu

11:00 PM Saturday

- Umpqua Star Fleet Battles (until 4:00 AM)
Jeff Clulow
- Nestucca Chill Legendary Lives (until 4:00 AM)
Karl Kreibiel

11:00 PM Saturday (cont'd)

Wallowa Champions (until 4:00 AM)
Ted Davis

SUNDAY

7:00 AM Sunday

Umpqua Magic (until 9:00 AM)
Calvin Taylor

Nestucca Cry Havoc PBM (until 2:00 PM)
James Wilsonsage

Wallowa Magic Tourney (until Noon)
Cthulhu

9:00 AM Sunday

Umpqua Chill Legendary Lives (until 1:00 PM)
Karl Kreibiel

Noon Sunday

Wallowa Toon (until 4:00 PM)
Rodney Barnes

1:00 PM Sunday

Umpqua Hot Death Uno Tourney (until 5:00 PM)
Pam Wilsonsage

2:00 PM Sunday

Nestucca Monopoly (until 5:00 PM)
James Wilsonsage

Map by David D. Levine

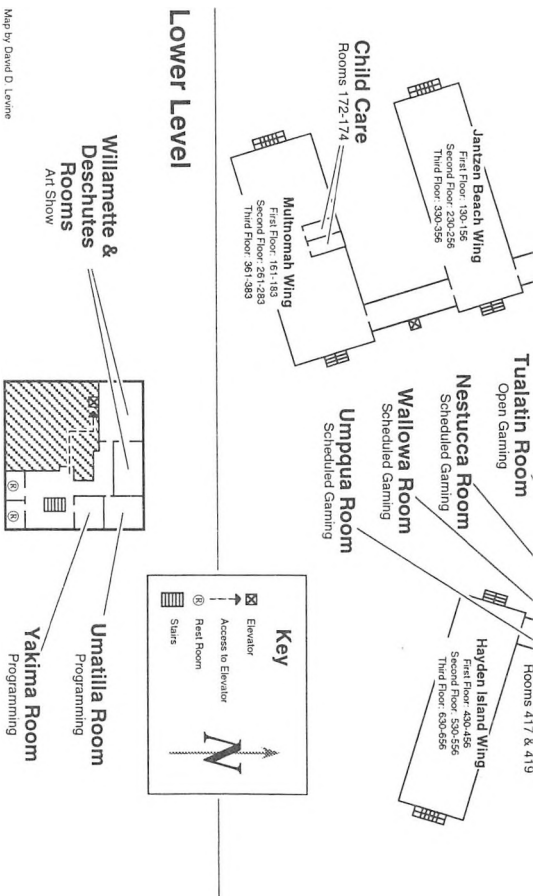

Upper Level

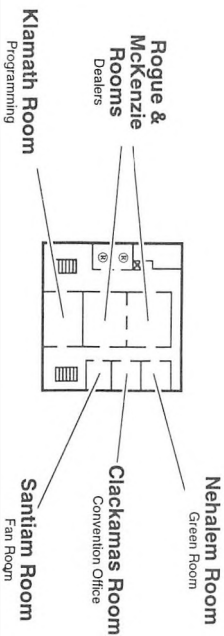

Ground Level

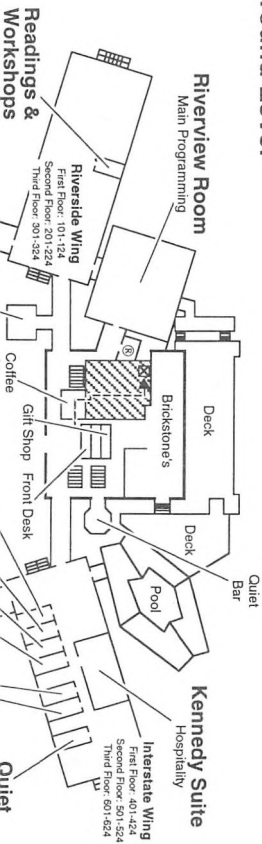

	Yakima	Umatilla	Klamath	Riverview	Video A	Video B
9AM						
10AM						
11AM						
Noon		Ultimate Interface				
1PM	How Cons Treat Pros	Comics Not Big Two				
2PM	Get From Writer's WS	Third World				
3PM	SF & Fantasy Poetry	Art & Art Shows	Craters of Doom			
4PM	Remove Your Religion	Techno-speak	Creative Process		Matinee	UHF
5PM	Adaptation or Exploitation?	Wizards of the Coast	Cadigan Interview		Day of the Triffids (5:38)	Abraxas: (5:37)
6PM	A Civilized Ideal	Folk & Fant. Musical con.	Fanthorpe Reading			
7PM				Set Up	Brain From Arous (7:16)	Solar Crisis (7:07)
8PM				Open. Cer.		
9PM	Costume Con 14	Trivia Quiz	Concerts: Dixon, Neason, Prescott, Scarborough, Fanthorpe, Eng	Dance (after Opening Ceremonies)	I Married a Monster... (8:36)	Repo Man (8:57)
	Blood Fleet					
10PM					Stepmother is an Alien (9:54)	Blade Runner Director's Cut
11PM					Earth Girls Are Easy (11:42)	
Midnight			Bardic Circle Filk			

Rogue/ McKenzie Willamette/ Deschutes Santiam Room 114 Nestucc Wallowa Umpqua

							9AM	
	Artists' Check-in						10AM	
							11AM	
							Noon	
Dealers' Room							1PM	
	Art Show						2PM	
								3PM
				Wheeler				4PM
		Fan Room		Hartman	Magic	Magir		
				Elliott				
				Lyris				
				A. M-Brms				
				S. Barnes	Cry Havoc	Ethos ('till 1:00AM)		Starfleet Battles
				Branham				
			Bunnell					
	Fan Room	Rosenblm						
	Fano-rama	Vukcevch						
	Fan Room							
						8PM		
						9PM		
						10PM		
						11PM		
			Horror Reading	Magic ('till 4:00AM)		Robin Hood ('till 4:00AM)	Mid-night	

	Yakima	Umatilla	Klamath	Riverview Room/Stage		Video A	Video B
9AM	SF Museum			Tai Chi		One Million B.C. (8:55)	Cereal and Toons!
10AM	Christian Fandom	Write Story age 5-14	Ask Dr. Genius	SCA Demos			Fahrenheit 451 (10:15)
11AM	Humorous Fantasy	High School Writers WS	Research Alt. History				
Noon	Running Small Cons	Younger Music	Nothing In Particular	Small Grps	Move- ment in	Millennium (12:07)	Zeram (12:10)
1PM	Faire & Filk Music	Karate: 16 and Under	Editor Wants a Rewrite	pg. 8	Costume		
2PM	Believable Fantasy	First Fandom	King, Meacham	Small Grps	Stage Perform	Alphaville (1:55)	Star Knight (1:48)
3PM	Trading Card	Two Steves	Musgrave Slide Show	pg. 10	Costume		
4PM	Smart Kids	Multi- culturalism	Setup Sue Petrey	Small Grps	Masq. Practice Sign-up req.	Solaris (3:35)	The Abyss (3:18)
5PM	Place in Fantasy	Cyberpunk Women	Auction	pg. 11			
6PM	New Age etc. Music	Getting Noticed	Whose Line Is It Anyway?	Masq. Setup		Outer Limits (6:22)	The Aurora Encounter (6:05)
7PM		Buck Meets Spotted Owl					
8PM		Good Space Opera?	Bardic Cir- cle Filk	Masquerade		After Hours (7:22)	The 10th Victim (7:35)
9PM		Oak Island Mystery				Brazil (8:59)	Demolition Man (9:07)
10PM			Concerts: Alexander, Torley, Gaustad, Kom, Longcor	Dance Follows Mas- querade		Brain Dead (11:10)	Megaville (11:07)
11PM							
Mid- night						Dead Alive	Nemesis...

Rogue/ McKenzie	Willamette/ Deschutes	Santiam	Room 114	Nestucc	Wallowa	Umpqua		
							9AM	
Dealers' Room	Art Show		Writer's Workshop	Cry Havoc	Magic (starts at 7:00AM)	Jihad (starts at 7:00AM)	10AM	
A.M-Bms, York	Art Show Walk Thru	Gestetner & Modern					11AM	
Smith, Wheeler	Art Show	Fan Room					Noon	
Bischoff, Watrs								
Musgr, Org-Kn		Write For Fanzines?	Writer's Workshop				1PM	
Scbrgh, Vkcvc								
Fanthrp, Elliot		Fan Room					2PM	
S.Brns, Shckly					Chill	ITL	Battle-tech Tourney Lvl II	
King, Meachm			Fanzine Fandom	Good Fanthorp				3PM
McKnn, Nson				Bischoff				4PM
Rsch, Rsnblm			Fan Room	Scarborgh				
Dealers' Room				Rusch				5PM
			York					
			Smith				6PM	
			Forsythe					
			Neason				7PM	
				Magic Tourney	Magic Tourney	Battle-tech Tourney Lvl III	8PM	
		Fan Room					9PM	
							10PM	
				Chill Legendary Lives ('till 4:00AM)	Champions ('till 4:00 AM)	Starfleet Battles ('till 4:00 AM)	11PM	
			Horror Reading				Mid-night	

	Yakima	Umatilla	Klamath	Riverview	Video A	Video B
9AM				Tai Chi	... Tall Blond	Cereal and Toons
10AM		Mass w/ Rev Fanthorpe			Return of Tall Blond (9:46)	Selected Ernie Kovacs
11AM	Schools & Parents	Humorous SF	Horses and Fandom	Setup	Elmer Gantry (11:10)	Megaman
Noon	Masq. Debriefing	Business of Writing	Magazine Hell	Art Auction		
1PM	How to be a SMOF	Ukrainian Bandura	Volunteers Virtual Beer		Leap Of Faith (1:36)	Invasion Of The Space Preachers (2:15)
2PM	Onions & Orchids	Choc. Tasting (2:15)	Cats & Dragons	Claymation	Under Car (3:26)	
3PM	Drunken Revelry	Science & Religion	Science for Rocks			
4PM						
5PM						
6PM						
7PM						
8PM						
9PM						
10PM						
11PM						
Mid-night						

VIDEO

Once again OryCon is pleased to present these works of video greatness. You may watch these in rooms 417 (channel A) and 419 (channel B) just across the hall from Hospitality. You may also view them in your rooms. (Unfortunately, we won't know the channels for sure until the first day of the convention so channel surf or check the video rooms.)

Ratings have been provided for the videos so you can baby-sit your kids viewing habits as we cannot (and will not) do it for you.

Friday

- 4:00 pm **A** Matinee (PG)
This really happened. Really!
- 4:00 pm **B** UHF (PG-13)
Welcome to Cable.
- 5:37 pm **B** Abraxas: Guardian Of The Universe (R)
Terminator on valium.
- 5:38 pm **A** Day Of The Triffids (G)
Snapdragons on an Ortho high.
- 7:07 pm **B** Solar Crisis (PG-13)
Brought to you by Coppertone SPF 1,000,000.
- 7:16 pm **A** The Brain From The Planet Arous (G)
See What Happens when you don't clean the fridge.
- 8:36 pm **A** I Married A Monster From Outer Space (G)
Most say he was from Cleveland.
- 8:57 pm **B** Repo Man (R)
And you thought your life was normal.
- 9:54 pm **A** My Stepmother Is An Alien (PG-13)
Men: So What! Women: Men!!
- 10:30 pm **B** Blade Runner (director's cut) (R)
Better fun through chemistry.

- 11:42 pm **A** Earth Girls Are Easy (PG)
Says Who? (SM seeks E&G's. Call office if you're as cute and free as I'm old and broke.)

Saturday

- 12:27 am **B** Hardware (R)
Beware of boyfriends bearing strange robots.
- 1:22 am **A** The Abominable Dr. Phibes (PG)
Hey Doc pay malpractice insurance or else!
- 2:01 am **B** TC 2000 (R)
MW + PW brought her up right.
- 2:52 am **A** Dr Phibes Rises Again (PG)
Call I-ani-mat-ether.
- 3:37 am **B** Mad Max (R)
EXCOP+HELL=LETHAL VENGEANCE
- 4:21 am **A** Equinox (PG)
Where's Smokey when you need him?
 - OR -
- 4:21 am **A** Dementia (PG)
Castle for rent. Ax us about it.
- 5:10 am **B** Knights (R)
Warning to Vampire Cyborgs: Buffy she ain't.
- 5:41 am **A** Firewalker (PG)
Accept no substitutions (this is why.)
- 6:45 am **B** Dark Star (G)
Star Trek on LSD. (ST I was on Prozac.)
- 7:27 am **A** Encino Man (PG)
Reverse Culture Shock. Caveman is the normal one.
- 8:55 am **A** One Million B.C. (G)
Ten Dollar budget. Dino director.
- 9:00 am **B** Cereal and Toons
AKA: I need my caffeine and sugar or I'm nothing!
- 10:00 am **B** The Court Jester (G)
Bet you can't say it even once.
- 10:15 am **A** Fahrenheit 451 (G)
A Fundamentalist's wet dream and a biblioholics nightmare.

- 11:41 am **B** Teach 109 (G)
Love hurts.
- 12:07 pm **A** Millennium (PG-13)
Fly Never Airways.
- 12:10 pm **B** Zeram (rating unknown)
Hey it's better than Godzilla!
- 1:48 pm **B** Star Knight (PG)
David Bowie Mute Oh Joy!
- 1:55 pm **A** Alphaville (G to PG)
Philip Mallow's Bad Dream.
- 3:18 pm **B** The Abyss (PG-13)
I can't believe I watched the whole thing!
- 3:35 pm **A** Solaris (PG)
Oy Vay! Da Ruskies habedtooken ober hal platform.
- 6:05 pm **B** The Aurora Encounter (PG)
19th century antelope or boring today.
- 6:22 pm **A** 2 Outer Limits Episodes
You vatch you zen know vitch.
- 7:22 pm **A** After Hours (R)
I don't love New York.
- 7:35 pm **B** The 10th Victim (PG)
Tontine Lotto.
- 8:59 pm **A** Brazil (R)
The i's must be dotted and the t's must be crossed.
- 9:07 pm **B** Demolition Man (R)
- 11:07 pm **B** Megaville (R)
ESD+Chips+Politics = A Haha + Ow Ouch
- 11:10 pm **A** Brain Dead (R)
Hey boss - What was your doctor's name?

Sunday

- 12:35 am **A** Dead Alive (R?)
No this is not a documentary on the con committed.
- 12:43 am **B** Nemesis (R)
Hi FI good guy vs quad of bad guys or have solder gun will travel.
- 2:18 am **B** Neon City (R)
For ever seeking rainbows.

- 2:39 am **A** Videodrome (R)
Couch Potato Au Rotten.
- 3:57 am **B** The 27th Day (R)
Get that roach away from that catch!
- 4:06 am **A** The Quiet Earth (R)
You can hear a butterfly sneeze if there is one.
- 5:12 am **B** Hell Comes To Frogtown (R)
Every guy's (wet) dream AKA it's not easy being a mean green.
- 5:37 am **A** The Atomic Cafe (G)
If you're < 30 it's ha ha. If you're > 30 it's a refresher course.
- 6:40 am **B** Willow (PG)
Alias evil queen vs. Ah not again I want to see her win for a change.
- 7:09 am **A** Reefer Madness (PG)
No 'high' office for this guy. He Inhaled.
- 8:16 am **A** The Tall Blond Man With One Black Shoe (PG)
Jamie boy eat your heart out.
- 9:00 am **B** Cereal And Toons
Fuel up for da last until next year.
- 9:46 am **A** The Return of the Tall Blond Man With One Black Shoe (PG)
If miss Penny Sees him you're history.
- 10:00 am **B** Selected Ernie Kovacs
Animal right and ACLU call P.C. (AKA chimps jealous of Gorillas) etc.
- 11:10 am **A** Elmer Gantry (G)
The plate will be passed no wooden nickles please.
- Noon **B** Megaman
- 12:30 pm **B** Two Mules For Sister Sara (PG)
Sister act seeks Dirty Harry. Object: big bang.
- 1:36 pm **A** Leap Of Faith (PG-13)
Hangover cures extra.
- 2:15 pm **B** Invasion Of The Space Preachers (G?)
The PTL training film.
- 3:26 pm **A** Under The Car (PG-13)

RESTAURANT AND SERVICES GUIDE

Welcome to yet another OryCon weekend at Hayden Island. The Columbia River and Jantzen Beach Shopping Center (JBSC) frame the Red Lion/Columbia (RL/C). Quick access to food, shopping, and a carousel are within walking distance, all accompanied by a challenging experience of dodging cars, trucks and other pedestrians to reach the mall. In other words, watch your step when you go to JBSC, it's still a labyrinthine puzzle to get from here to there.

I-5 is the modern Oregon Trail to Vancouver, Portland and all points beyond. Vancouver is just over the interstate Bridge, and the bulk of Portland lies to the south of the RL/C. There are other access routes to both, but we don't want to get you hopelessly lost during your time here.

Downtown Portland is 7 miles south on I-5, accessible by both car and bus. If you want to spend the bulk of your time at the Con (don't we all), you are slightly in bondage to the Island, but if you are one of those who needs a break, there are a number of food and entertainment offerings for the fannish explorer who wishes to have her/his own adventures.

Remember to make reservations at any restaurant that isn't a fast-food, pizza or Denny's clone. Large groups are welcome at any restaurant with enough notice, but subject to the big hairy eyeball if they show up without warning. There are a number of specialty restaurants in the area, and copies of the Oregonian A & E and the Willamette Week restaurant guides will be available for your perusal. Ask at the Information Desk. The listings included are just suggestions, and the "tip of the iceberg" for local dining and entertainment.

RED LION DINING

There are several Red Lion Inns in the Portland/Vancouver area, and all of them feature opportunities for dining roughly equivalent in format to RL/C. Each has a Coffee Garden for informal dining and also a fine dining facility. If you are one of those folk who reserved your room here with a Visa or MasterCard, you can dine at *any* Red Lion restaurant and charge your food and drink to your room account. Also, if you want to dine at either the Red Lion/Jantzen Beach or the Inn At The Quay (in Vancouver), you can make reservations at the restaurants at either and also reserve the shuttle to take you back and forth between these three Red Lions. You need to give the shuttle service *at least* one hour's notice if you plan to take advantage of these dining Options.

It's also possible (but terribly convoluted) to take the RL/C shuttle to the Airport, then take the RL/Lloyd Center or RL/Downtown shuttle from the airport to either place and repeat the process to come home. It depends on how much time you want to spend at Portland International between shuttles.

RED LION/COLUMBIA

Brickstones Bar - 240-4291

M-F 11:30am-midnight; Sa-Su 11:30am-1:30am

Food & drink available, sometimes handles overflow from Brickstones Restaurant. TV is one of the specialties of the bar, making it difficult to do more than eat, drink, space out on the nearest TV screen or gaze into your sweetie's eyes. Conversation is out unless you are invested in developing laryngitis.

Brickstones Restaurant - 240-4567

Lunch: M-F 11:30am-2pm; Dinner: Sun-Thur 5-10pm; Sa-Su Brunch, 8:00am to 1:30pm; Dinner 5-11pm

Slower during peak service hours, can flow over into the Quiet Bar or Brickstones Bar. Pricy, but good food. (or see RL/JB or Inn At The Quay)

Quiet Bar - 283-2111, ext. 4627

Usually open Friday & Saturday 8pm to midnight. (check to see if our negotiations for extended hours during the Con were successful)

Meals can be ordered here, and its *minus* the TV mania, but people who have trouble consuming smoke may have problems breathing here without a gas mask (They should have named it the Quiet Smoky Bar; you may have to look hard to find the friends you agreed to meet here.)

Red Lion Coffee Garden - 283-2111, ext. 4412

Usual hours 6am-midnight.

The Coffee Garden is a Red Lion's institution, and the best place to be able to *find* the party you agreed to meet here. The hours are pretty good, but for even later or earlier rendezvous, Denny's is open 24 hours. CG has the best prices in the Red Lion, and a fair variety. Vegetarian is available.

RED LION/JANTZEN BEACHMaxi's - 283-4466**INN AT THE QUAY- 100 Columbia, Vancouver, WA**Pacific Grill & Chowder House - Portland #: 285-0636

6am-11pm; Sun. brunch 9am-2pm (\$9.95 Adults, \$5.95 children) See above for shuttle info.

RED LION/LLOYD CENTER - (281-6111)

Maxi's - ext. 4123

Dinner: wkdays 5-10pm; F & Sa: 5-11pm; Su Brunch: 9am-2pm

Coffee Garden - ext. 4145

6am to midnight.

Eduardo's Margarita Grill - ext. 4107

Lunch 11am-2pm; dinner hrs same as Maxi's

Traditional Mexican food; specialty "creative" enchiladas; family dining in Restaurant section; adults only in the Cantina.

JANTZEN BEACH MALL

Open M-F 10-9; Sa 10-6; Sunday 11-6. (Most fast-food places will accept take-out orders.) #'s refer to Area Map on page 45

7 Blue Heron Coffee - 735-3986

4 Cinnabon - 289-2917

Cinnamon rolls & sandwiches.

1 Dairy Queen - 285-4121

For DQ addicts.

5 Gyros, Gyros - 283-2171

Fast Greek, good and messy; gyros, souvlaki, falafel; all the usual Greek favorites. Best bet at JBSC.

2 Health Haus - 285-9724

Natural/health food; no restaurant.

3 Hot Dog On A Stick - no phone

Just what it says.

K Little Ceasars Pizza - 283-4670 (in Kmart)

For the truly desperate pizza bound.

- 8 Mrs. Fields Cookies - 283-5040
- 10 Old Holland Bakery - 283-1575
Bakery goodies & lunch stuff.
- 11 Orange Julius - 289-1902
Hot dogs, burgers &, Orange Julius, of course.
- 6 Sundaes West - 283-4252
Breakfast, burgers, sandwiches & no, I won't call it ice cream; the soft stuff; Coffee Garden has the *real* thing.
- 9 Yonny Yonsons - 289-2003
Sit-down cafe; sandwiches, soups, frozen yogurt. Box lunches available.

WEST OF I-5

- 12 Denny's - 285-0735
open 24 hours
'nuff said!
- 14 McDonald's Hamburgers - 12005 N. Center; 289-2127
6am-11pm Playland available
Standard Mickey D's fare.
- 13 Pietro's Pizza - 12115 N. Center; 289-5566
F & S 11am-11pm Su-Th 11am-10pm.
For the not quite as desperate Pizza hound.
- 15 Mt. Pizza, Deli & Pub - 11995 N. Center; 289-0336
m-Sa 10am-1am; Su 1-10pm.
For the Pizza hound: pizza, calzone, deli sandwiches, fried chicken & 200+ bottles of beer on the wall! Minors welcome in restaurant area; adults only in pub (but you knew this!).

- 16 Chang's Mongolian Grill 12055 N. Center; 240-0205
Lunch: 11:30am-2:30pm; Dinner: 5-10pm.
Select your own and the cooks stir fry it. All you can eat;
Reasonable prices; Half price for kids under 10. An OryCon family favorite!
- 17 Newport Bay 11950 N. Center; 283-3474
F-Sa 11-11; Sun 10-10
Combination menu/buffet brunch Sun 10-2; Seafood!! Fresh fish & non-marine options, as well. More reasonably priced than Red Lion seafood options, but no better than RL.

EAST OF I-5

PEDESTRIANS: to cross I-5 and live, go under it while still in the hotel parking lot.

- 18 Burger King - 12225 N. Jantzen; 285-5883
F-Sa 6:30am-11pm; Su-Thur 6:30-10pm.
For BK freaks or desperate parents!
- 19 Safeway Food Court - 11920 N. ML King Blvd
6am-11pm.
Sushi bar; Chinese food; deli with salads & cold cuts; "fry case";
espresso bar; juice bar, salad/sandwich bar.
- 20 Waddles - 11900 N. Martin Luther King Blvd.; 289-5538
Su-Thur 7am-10pm; Fr-Sa 7am-11pm.
Family-owned family restaurant; similar to Denny's a N. Portland classic.

VANCOUVER

Hong Kong Inn; 806 Broadway; (206)695-1553

Fr 11am-10pm; Sa noon-10pm; closed Sunday.

Mandarin & Szechuan. Okay Chinese; Take I-5 north to exit 1C, left on Mill Plain Blvd., left on Broadway, six blocks down on the left in the SeaFirst Bldg.

Peking Garden - 2101 Main St.; (206)699-1005

Fr 11-11; Sa 4-11; Su 4-9:30.

Good basic Chinese. Take I-5 north to exit 1D, left on Fourth Plain Blvd., left on Main St. at the light, a couple blks don on left.

Returning to RL/C, take Broadway (behind the restaurant) back to Fourth Plain. Turn right & merge left many lanes quickly. (Whew!!)

Royal India Cuisine - 316 SE 123rd, Suite D1

Asian/Indian; (off Mill Plain behind the Mai Tai Restaurant (1-205 best for access, take Mill Plain Exit). Rave reviews from the local gourmets.

Stuart Andersons - 415 E 13th; (206)695-1506

For the Serious steak freak on a medium budget.

TeeDee's Pie House - 6600 NE Hwy. 99; (206)695-1506

Family dining; late hours; best pie selection in the Metropolitan area with the closure of Quality Pie (sob).

Who Song & Larry's Cantina - 111 Columbia Way; (206)695-1198

Large Mexican sit-down restaurant. Call ahead for a group.

Entertainment

JANTZEN BEACH

- 21 Carousel - Mall
M-F 10-9; Sa 10-6; Su 11-6
50 cents per ride or 3 for \$1.00.
- 22 Toys R Us - SW corner of the mall parking lot; 289-4691
9:30-10pm daily.

PORTLAND

Children's Museum - 3037 SW 2nd Ave.; 823-2227

Daily 9am-5pm

Admission \$3.50 for everyone over age 1.

Cowboy's Then & Now Museum - 729 NE Oregon, Suite 190;
731-3200

Wed-Fr 11am-5pm; Sa & Su noon-5pm.

Discovery Zone - Lloyd Center; 288-2900

Mostly for kids

Murder Served Hot at the Portland Inn - 1414 5W 6th at Clay;
524-4366

By special reservation. Every weekend.

Powells City of Books- 1005 W Burnside - 228-4651

Oregon Museum of Science & Industry (OMSI) - 1945 SE Water
Ave.; 797-4000

Winter hours: 9:30pm-5:30pm, Thur-Fr 9:30am-9pm.

Current exhibit; OMNIMAX; Sky Theater; Submarine Tour; Laser
Light Show. Strollers & wheelchairs available. Smoke-free.

Oregon Maritime Center & Museum - 113 5W Front Ave.; 224-7724
Fr-Su 11am-4pm.

Washington Park Zoo - 4001 S.W. Canyon Rd.; Portland; 226-1561
open 9:30am daily
Admission charged. Strollers available.

Portland Art Museum - 1219 5W Park at Jefferson; 226-2811
Tu-Sa 11am-5pm; Sun 1-5pm.
Adults \$4.50; Srs. \$3.50; Students \$2.50; Family \$10.00; children
under 5 Free; Wheelchair accessible; smoke-free.

VANCOUVER

Discovery Zone - (206)254-2900

General Services

Bank Machines

All have Accel, Cirrus, Exchange, Plus, Visa & MC symbols

- 23 Bank of America, north side of the mall
- 24 First Interstate Bank, near Burger King
- 19 UBank machine in Safeway
- 25 US Bank, next to the hotel, off the Multnomah wing
- 26 Liquor Store - 11915 N Center; 283-2907; 10-7; closed Sunday
- 27 Plaid Pantry - 1463 N. Hayden Island Dr.; 285-5576
- 19 Safeway Supermarket - 11920 N. Martin Luther King Blvd.

Tri-Met (Portland's Bus System) Schedules & info; 7:30-5:30pm - weekdays; 238-RIDE (TDD: 238-5811) Call-a-bus 24-hr Recording 231-3199 (TDD: 239-3010)

Crisis Intervention Services

Alcohol & Drug Helpline 232-8083; Youthline 233-1113

Alcoholics Anonymous (24 hr. hotline) 223-8569

Al-Anon/Alateen 292-1333

Metro Crisis Hotline 223-6161

Emanuel Hospital & Health Center; 2801 N. Gantenbein, Portland; emergency 24-hour service; 280-4128.

Portland Women's Crisis Line 235-5333

Oregon Poison Center 494-8968

General Emergency 911

Narcotics Anonymous Hotline 233-2235

NOTES

OryCon 16

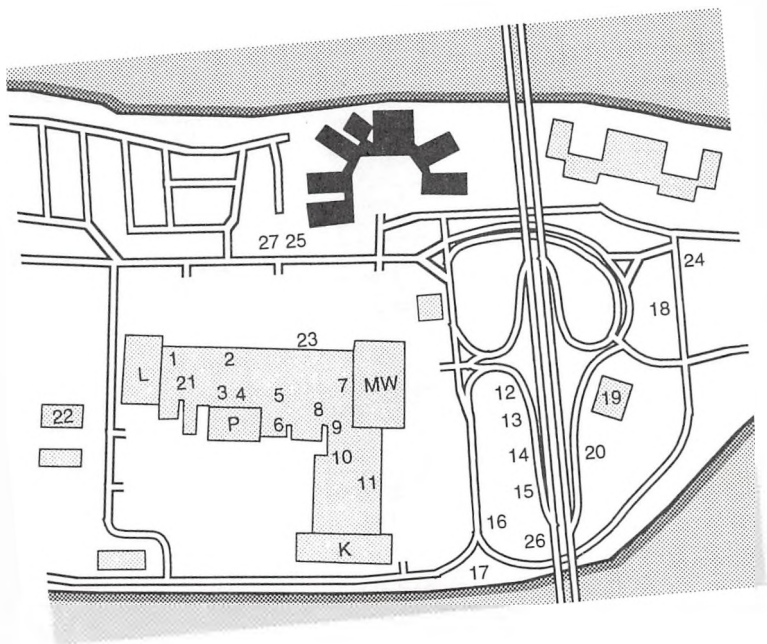
AREA MAP

OryCon 16 At A Glance

What	Where	Friday	Saturday	Sunday
Art Show	Willamette/ Deschutes	Check-in: 9AM-1PM Open: 2-7PM	10AM-8PM	Open: 9-11AM Auction: Riverview 11:30AM-1:30 Check-out: 3-5PM
Child Care	Rms. 172,174	4-10PM	10AM-11PM	11AM-4PM
Dances	Riverview	8:30PM- 3:30AM	After Masq. - 3:30 AM	N.A.
Dealers' Room	Rogue/ McKenzie	Noon-7PM	10AM-6PM	11AM-4PM
Fan Room	Santiam	4-6PM 8-11PM	11AM-6PM 9-11PM	11AM-4PM
Gaming	Tualatin Nestucca Wallowa Umpqua	4PM-4AM	8AM-4AM	8AM-5PM
Green Room	Nehalem (Opens 6PM Thursday)	10AM-6PM	8:30AM-9PM	8:30AM-3PM
Hospitality	Kennedy Suite	3PM-3AM	9AM-3AM	9AM-4PM
Masquerade	Riverview	N.A.	Masquerade: 8:00PM	Debriefing: 12-1PM Yakima
Office	Clackamas	8AM-4AM	8AM-4AM	8AM-4PM
Quiet Hospitality	Room 423	8:15PM-1AM	2-5PM & after Masq.-1AM	N.A.
Registration	Hotel Lobby	11AM-10PM (late night reg in office)	10AM-6PM	10AM-2PM
Video	Rms. 417,419	4PM-4AM	8AM-4AM	8AM-4PM